

# pottery barn kids

## TRAIN ENGINE TWIN BED

### PRE-ASSEMBLY:

- Please read all instruction before beginning assembly. The illustrations provided allow for easier assembly when used in conjunction with the assembly instructions.
- Remove all parts and hardware from box and lay out on a carpeted or scratch-free work surface, as this will avoid damaging any parts during assembly. The shipping box provides an ideal work surface. Do not dispose of any contents until assembly is completed to avoid accidentally discarding small parts or hardware.
- For your safety and ease, adult assembly by two people is recommended.
- Save all packing materials until assembly is complete to avoid accidentally discarding smaller parts or hardware.
- Use the parts and hardware lists to identify and separate each of the pieces included prior to starting assembly.
- Note: DO not fully tighten all bolts until all parts are in place. Failure to follow these instructions may cause the bolts to misalign during assembly.
- If using power tools to aid in assembly please use caution. Power tools can damage hardware or split wood.

### PARTS INCLUDED:

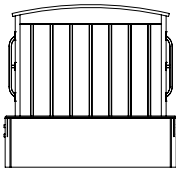
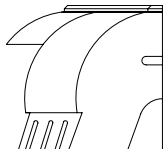
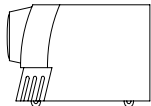
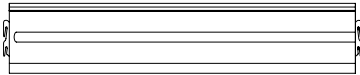
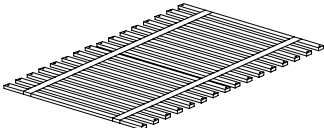
<b>A - Headboard (1 pcs) – Box 1</b> 	<b>B - Footboard (1 pcs) – Box 2</b> 	<b>E - Cart (1 pcs) – Box 3</b> 
<b>C - Side Rail (2 pcs) – Box 4</b> 	<b>D - Slat Roll (1 pcs) – Box 4</b> 	

### HARDWARE ENCLOSED:

<b>F - Wood Screw, 8 x 25 mm (32 pcs) – Box 1</b> 
--

### TOOLS REQUIRED:

Phillips Head Screwdriver (Not included)

#### ASSEMBLY INSTRUCTIONS:

1. Attach both Side Rails (C) to the Headboard (A) and Footboard (B) by inserting the hooks at two ends of Side Rail (C) into the slots on Headboard (A) and Footboard (B). Press down firmly to secure. Ensure that the decorative molding at one end of side rail is continuous to the decorative molding on the Headboard (A). Change the Side Rail (C) to opposite side if the decoration does not align. (Fig. 1)

Decorative molding at one end of side rail must be continuous to the decorative molding on the Headboard (A).

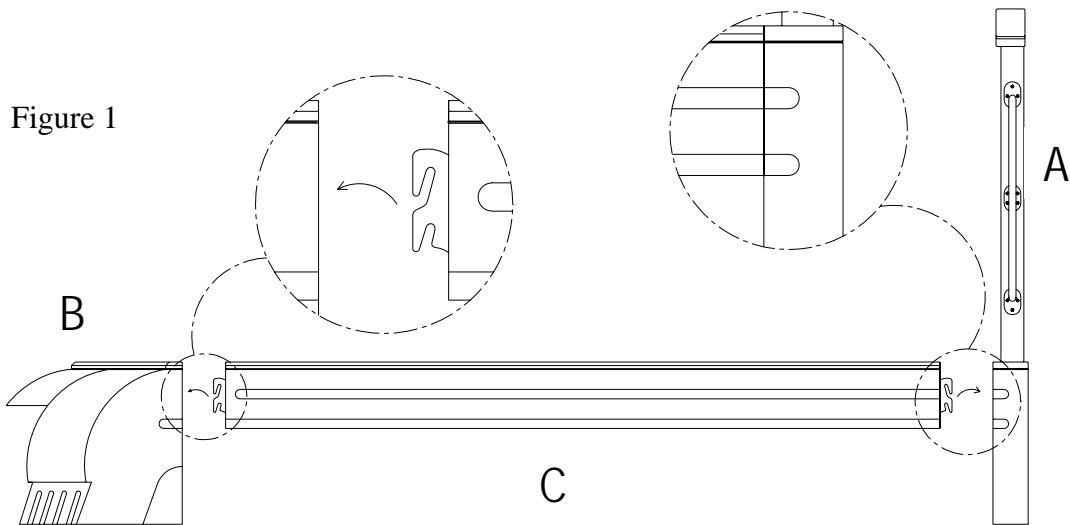

2. Lay the Slat Roll (D) between the Side Rails (C). Insert the Wood Screws #8 x 25 mm (F) into the pre-drilled holes on each rail and secure with Phillips Head Screwdriver. (Fig. 2)

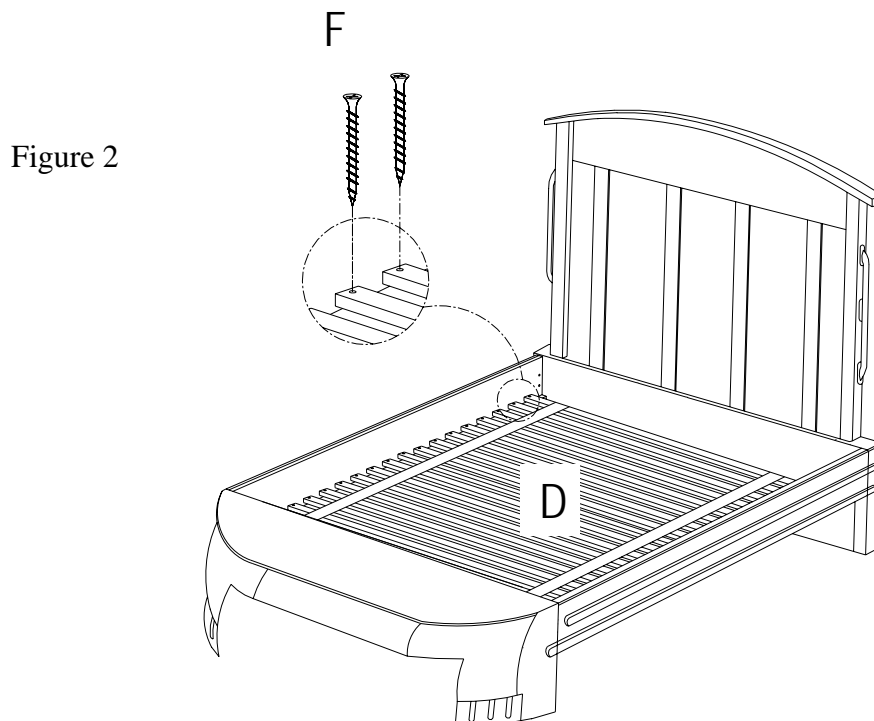

3. Unscrew the bolts attaching the wood block at back of the Cart (E), using the Phillips Head Screwdriver. Turn block upside down and reattach to the same holes (Fig. 3).

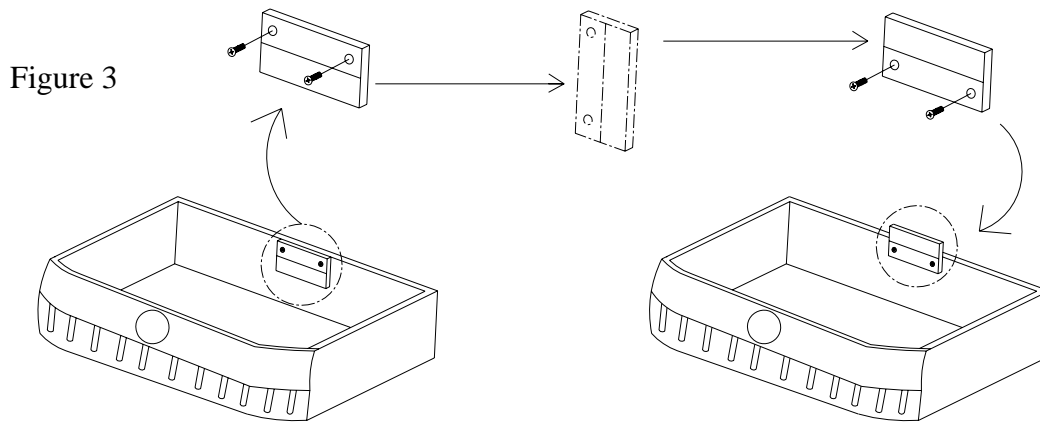

4. Align the Cart (E) with the space under the Footboard (B). Tilt the cart up at front until the wood block (which works as stopper) is lower than the height of the space under Footboard (B). Then, slowly move it into the Footboard (B) (Fig. 4).

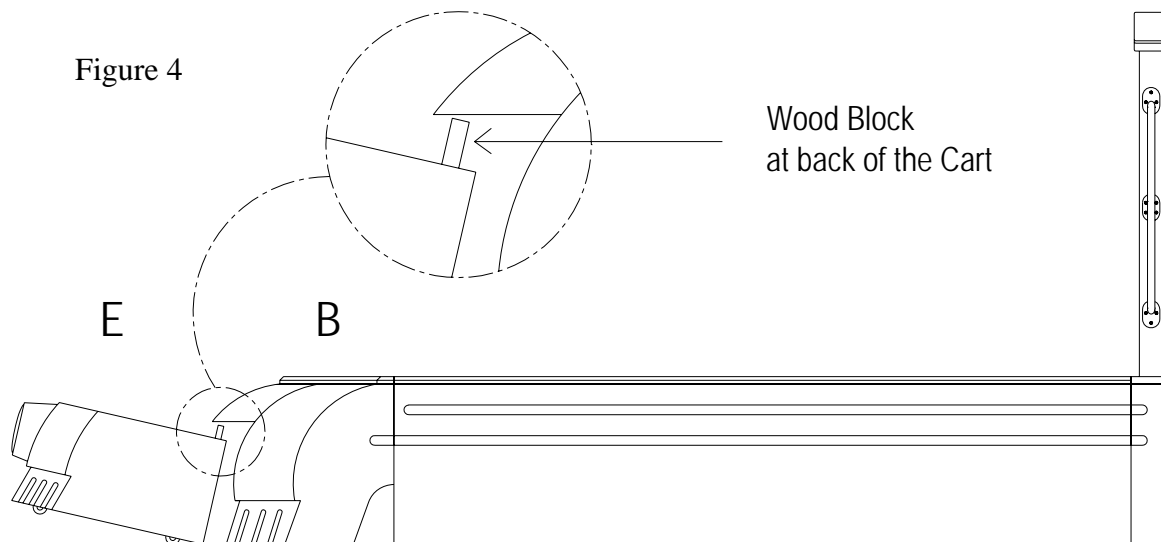

**CARE INSTRUCTIONS:**

- Dust often using a clean, soft, dry lint-free cloth.
- Blot spills immediately, and wipe with a clean, damp, cloth.
- We do not recommend the use of chemical cleaners, abrasives, or furniture polish on our lacquered finish.

Thank you for your purchase.  
stores | catalog | [www.potterybarnkids.com](http://www.potterybarnkids.com)  
USA 1.800.290.8181