

pottery barn kids

BERKELEY ARMOIRE

PRE-ASSEMBLY:

- Read all instructions before beginning assembly. The illustrations provided allow for easier assembly when used in conjunction with the assembly instructions.
- For your safety and ease, assembly by two adults is recommended.
- Remove all parts and hardware from the box and lay out on a clean, carpeted, or scratch-free work surface. Use care as some parts or hardware may have sharp points or edges.
- Do not dispose of any contents until assembly is completed to avoid accidentally discarding small parts or hardware.
- Use the parts and hardware lists to identify and separate each of the pieces included.
- Note: Do not fully tighten all bolts until all parts are in place. Failure to follow these instructions may cause the bolts to misalign during assembly.
- The use of power tools for assembly is not recommended. Power tools can damage hardware or split wood.

PARTS INCLUDED:

- (A) Armoire - 1pc
- (B) Legs - 4pcs
- (C) Removable shelf - 2pcs

HARDWARE ENCLOSED:

- (D) Shelf Supports - 8pcs

TOOLS REQUIRED:

Phillips head screwdriver (not included)

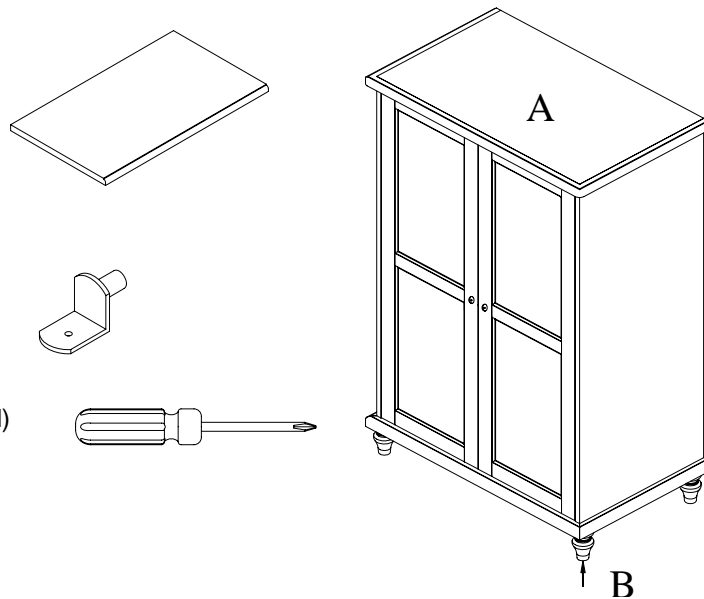

ASSEMBLY INSTRUCTIONS:

1. Lay Armoire (A) down on a soft surface such as a carpet. Attach the legs (B) to the Armoire (A) (see Fig. 1).

(Fig. 1)

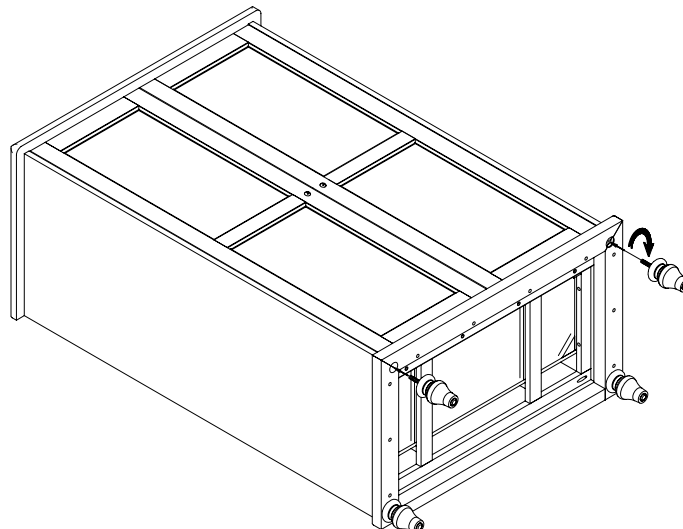

2. Turn the Armoire (A) upright. Open all the doors. The wooden knobs are pre-attached at the back of doors. Use Phillips head screwdriver (not included) to turn the screw counter clockwise until remove knob from the door. Repeat until all Knobs are detached (see Fig. 2).

(Fig.2)

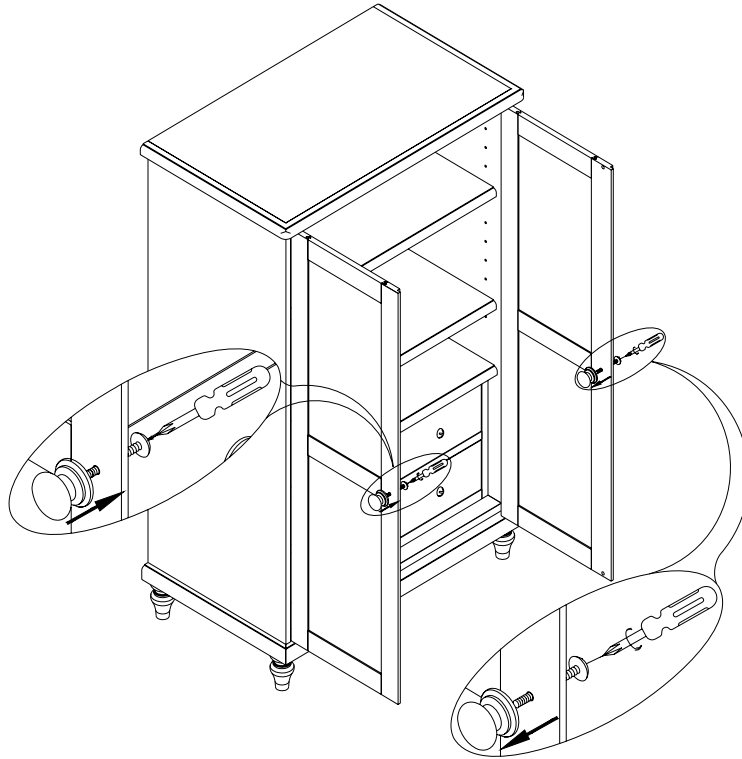

3. Pull out all the interior drawers. The wooden knobs are pre-attached at the back of drawer fronts. Use Phillips head screwdriver (not included) to turn the screw counter clockwise until remove knob from drawer front. Repeat until all Knobs are detached (see Fig. 3).

(Fig.3)

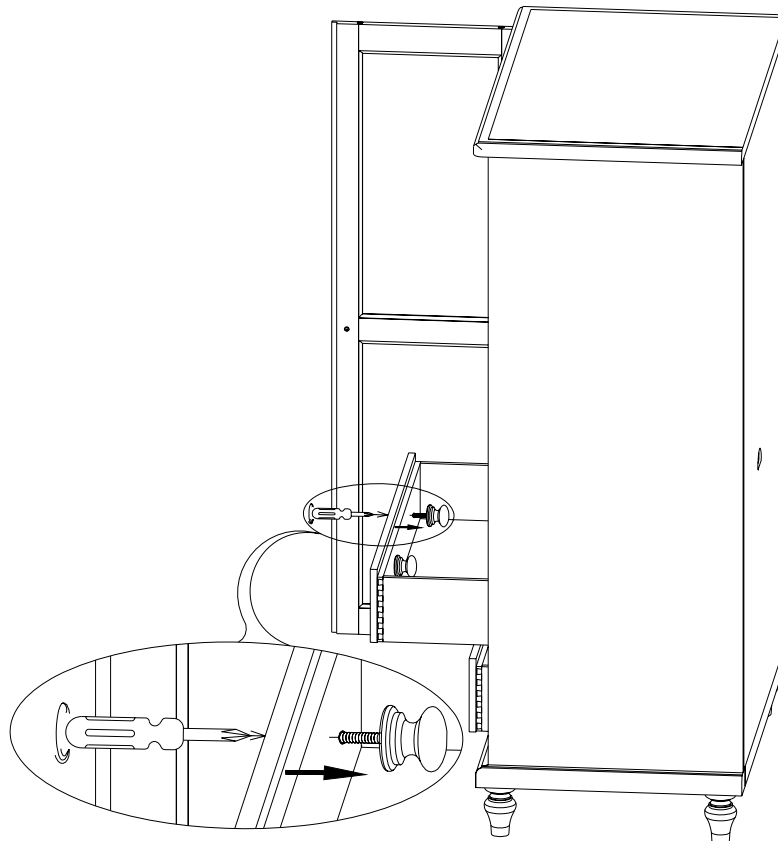

4. Attach knobs to drawers using Phillips head screwdriver, as shown below. Repeat until all Knobs are re-attached (see Fig. 4).

(Fig.4)

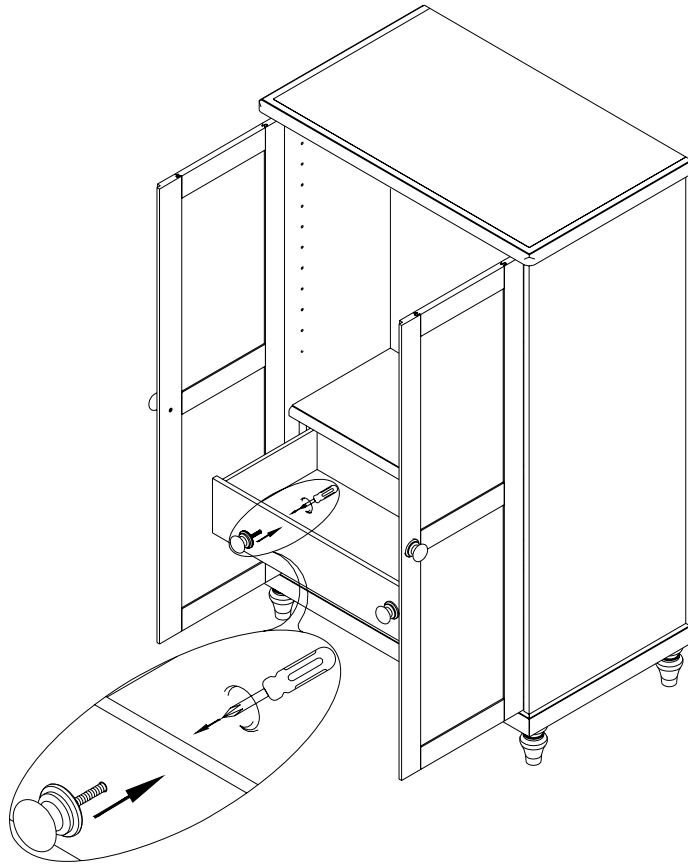

5. Determine the desired height for the Adjustable shelf (C). Insert the (8) Shelf Supports (D) into the pre-drilled holes on the inner side panel of Armoire (A). Carefully place the Adjustable shelf (C) onto the Shelf Supports (D). Make sure each Adjustable shelf (C) is properly supported by all (4) Shelf Supports (D) (see Fig. 5).

(Fig.5)

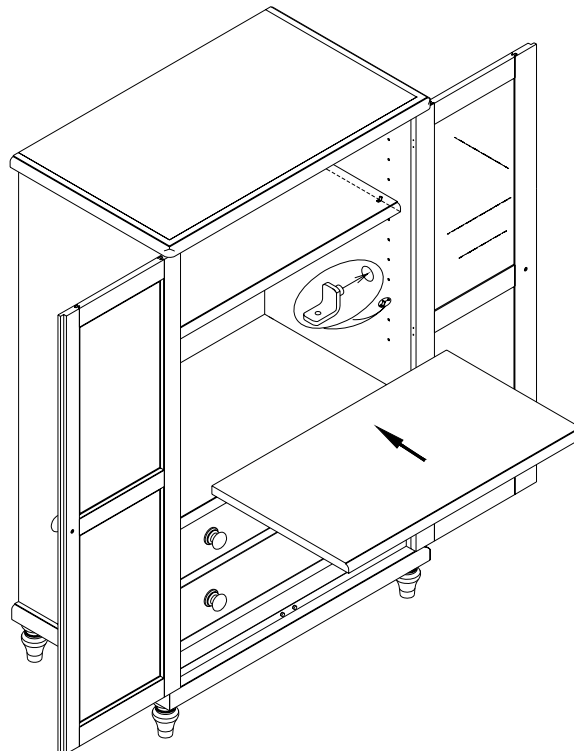

6. If your floor is not perfectly even, the furniture may not sit level. If the piece is not level, determine which corner does not touch the ground correctly. Follow these steps:
- Carefully elevate the item slightly to provide access to the levelers attached to the bottom.
 - Turn the levelers in a counter-clockwise direction.
 - Gently set down the piece and check stability.
 - Repeat steps until the furniture sits firmly on the ground (see Fig. 6).

(Fig.6)

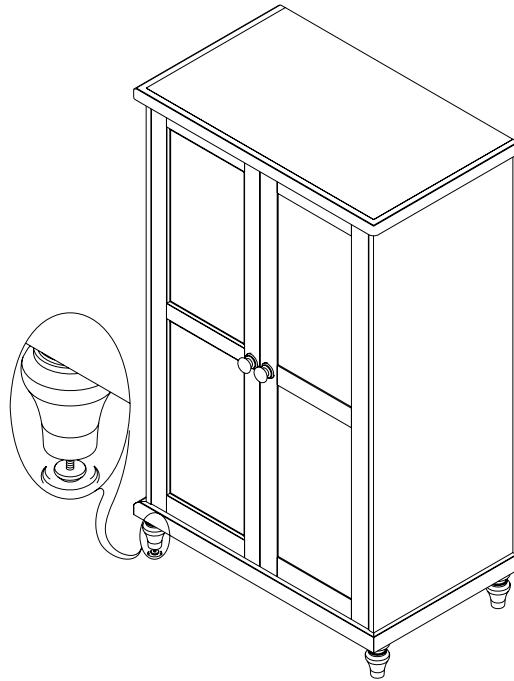

CARE INSTRUCTIONS:

- Dust often using a clean, soft, dry lint-free cloth.
- Blot spills immediately, and wipe with a clean, damp, cloth.
- We do not recommend the use of chemical cleansers, abrasives, or furniture polish on our lacquered finish.

Thank you for your purchase
stores | catalog | www.potterybarnkids.com
USA 1.800.290.8181